

- NOTES:
- MATERIAL: 316L STAINLESS STEEL, NICKEL BRAZED.
  - PRODUCT CONTACT SURFACE FINISH CODE PER ASME-BPE:  
SF1: 20  $\mu$ in. (.5  $\mu$ m) Ra MAX  
SF4: 15  $\mu$ in. (.4  $\mu$ m) Ra MAX, ELECTROPOLISHED.
  - ALL EXTERNAL SURFACES SATIN FINISH.
  - MAXIMUM OPERATING CONDITIONS:
    - PRESSURE: TUBESIDE - 1200 psi (83 bar)  
SHELLSIDE - 800 psi (55 bar)  
(REFER TO SANITARY CLAMP MANUFACTURER FOR CLAMP PRESSURE RATING)
    - TEMPERATURE: 800°F (425°C)
    - PRESSURE FOR STEAM SERVICE: 125 psi (8.6 bar)
    - FLUID TEMPERATURE DIFFERENCE:  
(T<sub>HOT</sub>)<sub>AVE</sub> - (T<sub>COLD</sub>)<sub>AVE</sub> ≤125°F (70°C)
  - FULLY DRAINABLE ON TUBESIDE.
  - MATERIAL AND PROCESS CERTIFICATIONS PROVIDED.

- #	TUBE COUNT	TUBE LENGTH		PRODUCT CONTACT SURFACE FINISH (NOTE 2)	CONFIG.	DIMA		DIMB		WEIGHT EMPTY		TRANSFER AREA	
		in	mm			in	mm	lb	kg	ft²	m²		
- 01	55	10.00	254	SF4	V	10.30	262	7.50	191	3.19	1.4	1.33	0.12
- 02		15.00	381			15.30	389	12.50	318	4.59	2.1	2.08	0.19
- 03		20.00	508			20.30	516	17.50	445	5.54	2.5	2.83	0.26
- 04		25.00	635			25.30	643	22.50	572	6.30	2.9	3.58	0.33
- 05		30.00	762			30.30	770	27.50	699	7.09	3.2	4.33	0.40
- 06		40.00	1016			40.30	1024	37.50	953	7.84	3.6	5.83	0.54
- 07		10.00	254	SF1		10.30	262	7.50	191	3.19	1.4	1.33	0.12
- 08		15.00	381			15.30	389	12.50	318	4.59	2.1	2.08	0.19
- 09		20.00	508			20.30	516	17.50	445	5.54	2.5	2.83	0.26
- 10		25.00	635			25.30	643	22.50	572	6.30	2.9	3.58	0.33
- 11		30.00	762			30.30	770	27.50	699	7.09	3.2	4.33	0.40
- 12		40.00	1016			40.30	1024	37.50	953	7.84	3.6	5.83	0.54
- 13	91	10.00	254	SF4		10.30	262	7.50	191	3.19	1.4	1.66	0.15
- 14		15.00	381			15.30	389	12.50	318	4.59	2.1	2.59	0.24
- 15		20.00	508			20.30	516	17.50	445	5.54	2.5	3.53	0.33
- 16		25.00	635			25.30	643	22.50	572	6.30	2.9	4.46	0.41
- 17		30.00	762			30.30	770	27.50	699	7.09	3.2	5.39	0.50
- 18		40.00	1016			40.30	1024	37.50	953	7.82	3.5	7.26	0.67
- 19		10.00	254	SF1		10.30	262	7.50	191	3.19	1.4	1.66	0.15
- 20		15.00	381			15.30	389	12.50	318	4.59	2.1	2.59	0.24
- 21		20.00	508			20.30	516	17.50	445	5.54	2.5	3.53	0.33
- 22		25.00	635			25.30	643	22.50	572	6.30	2.9	4.46	0.41
- 23		30.00	762			30.30	770	27.50	699	7.09	3.2	5.39	0.50
- 24		40.00	1016			40.30	1024	37.50	953	7.82	3.5	7.26	0.67

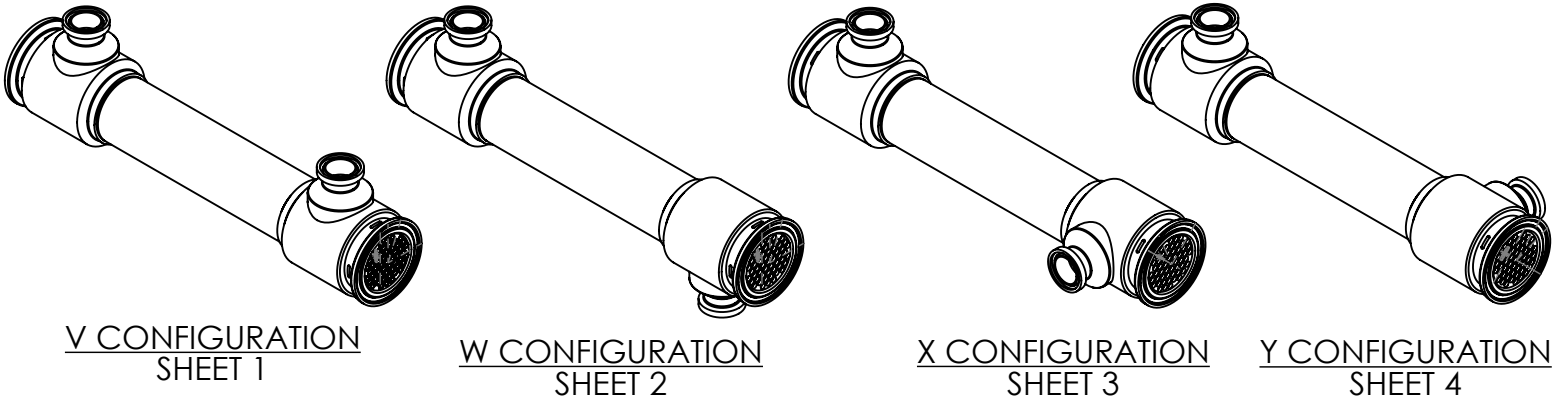
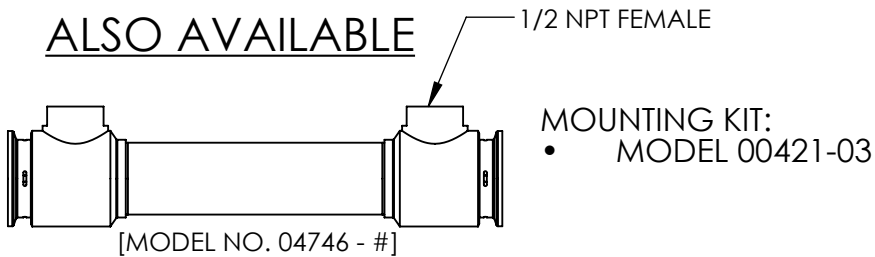
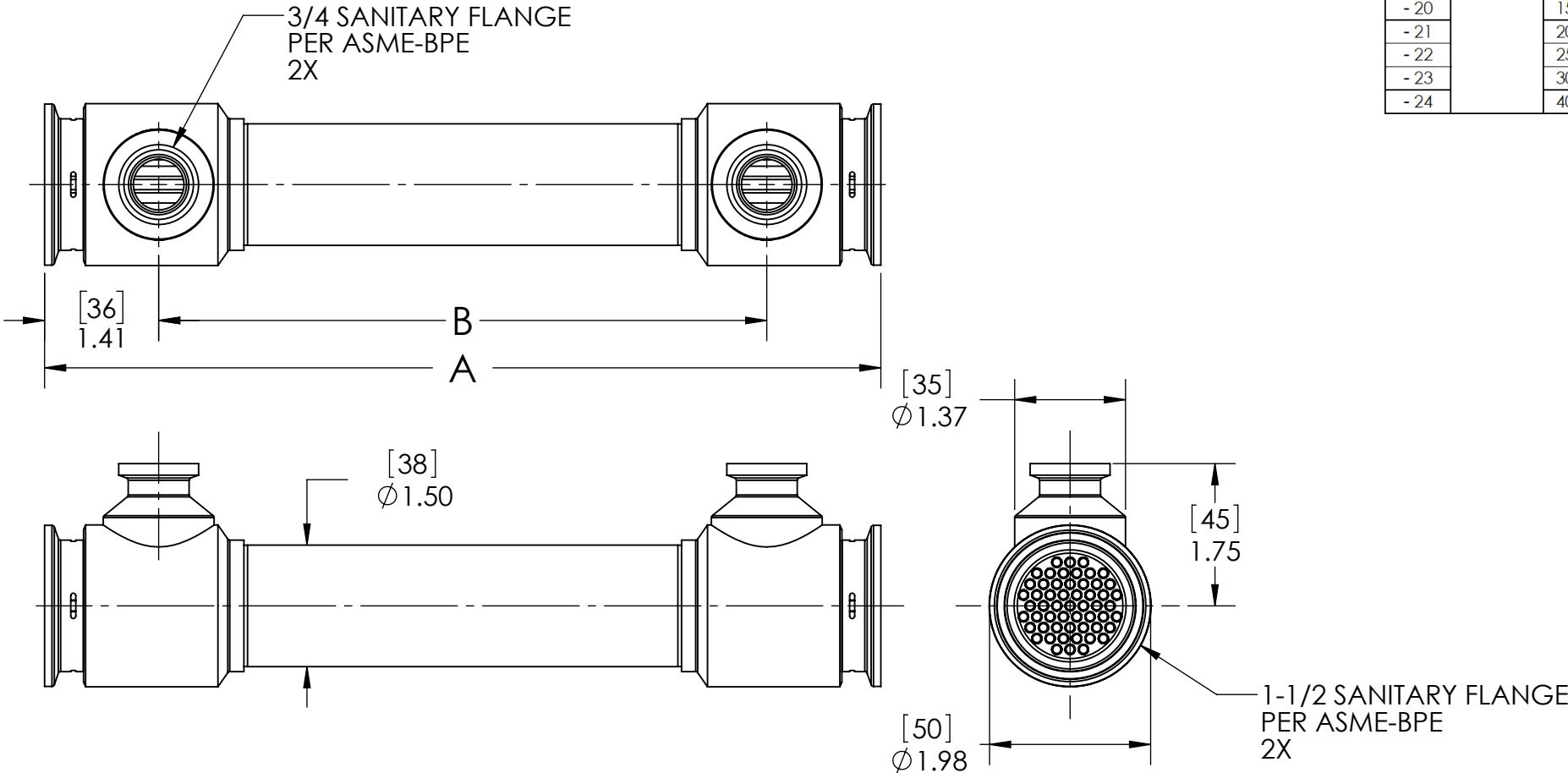

ALL DIMENSIONS ARE IN INCHES [mm]

**PROPRIETARY AND CONFIDENTIAL**  
THE INFORMATION CONTAINED IN THIS DOCUMENT IS THE SOLE PROPERTY OF EXERGY, LLC. ANY REPRODUCTION, DISCLOSURE, OR USE, IN PART OR AS A WHOLE, WITHOUT THE WRITTEN PERMISSION OF EXERGY, LLC IS PROHIBITED.

PRODUCT SPECIFICATIONS SUBJECT TO CHANGE WITHOUT NOTICE. MANUFACTURER ASSUMES NO LIABILITY FOR MISUSE OR ABUSE OF PRODUCT. SPECIFIC WARRANTY INFORMATION IS AVAILABLE UPON REQUEST.

THIRD ANGLE PROJECTION

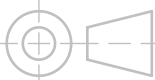

**EXERGY**  
HEAT TRANSFER SOLUTIONS

320 ENDO BLVD.  
GARDEN CITY, NY 11530  
USA (516)832-9300  
www.exergyllc.com

SHELL & TUBE HEAT EXCHANGER  
35 SERIES SANITARY  
DTS, SANITARY ALL, RUGGED, HiP CLAMP

MODEL NO. 04745- #

DATE 4/6/2023 SCALE 1:2 SHEET 1 OF 4

MODEL NO.

04745- #

- NOTES:
- MATERIAL: 316L STAINLESS STEEL, NICKEL BRAZED.
  - PRODUCT CONTACT SURFACE FINISH CODE PER ASME-BPE:  
SF1: 20 µin. (.5 µm) Ra MAX  
SF4: 15 µin. (.4 µm) Ra MAX, ELECTROPOLISHED.
  - ALL EXTERNAL SURFACES SATIN FINISH.
  - MAXIMUM OPERATING CONDITIONS:
    - PRESSURE: TUBESIDE - 1200 psi (83 bar)  
SHELLSIDE - 800 psi (55 bar)  
(REFER TO SANITARY CLAMP MANUFACTURER FOR CLAMP PRESSURE RATING)
    - TEMPERATURE: 800°F (425°C)
    - PRESSURE FOR STEAM SERVICE: 125 psi (8.6 bar)
    - FLUID TEMPERATURE DIFFERENCE:  
 $(T_{HOT})_{AVE} - (T_{COLD})_{AVE} \leq 125^{\circ}F (70^{\circ}C)$
  - FULLY DRAINABLE ON TUBESIDE.
  - MATERIAL AND PROCESS CERTIFICATIONS PROVIDED.

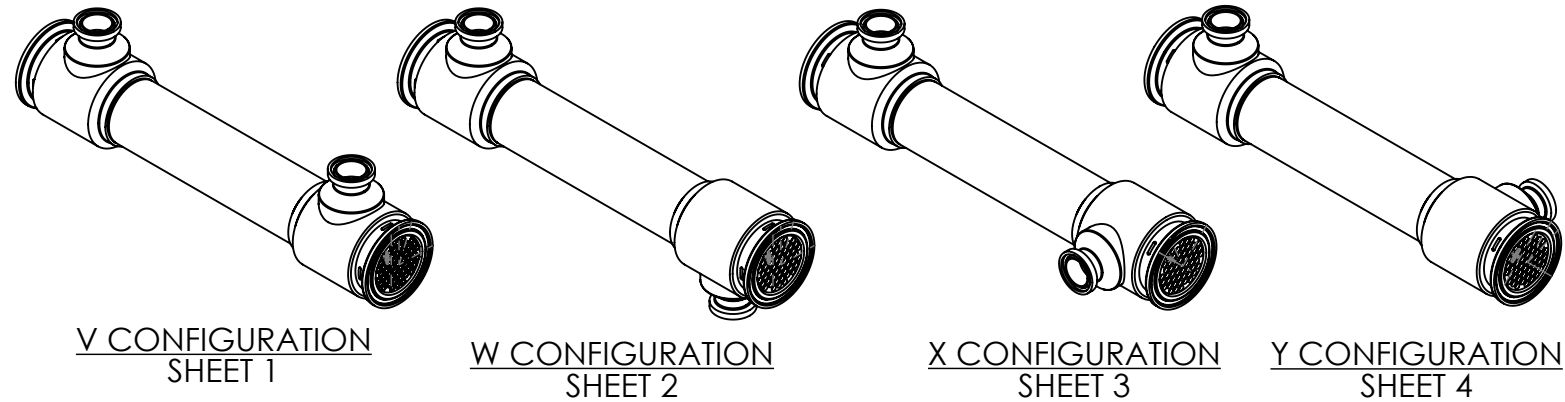
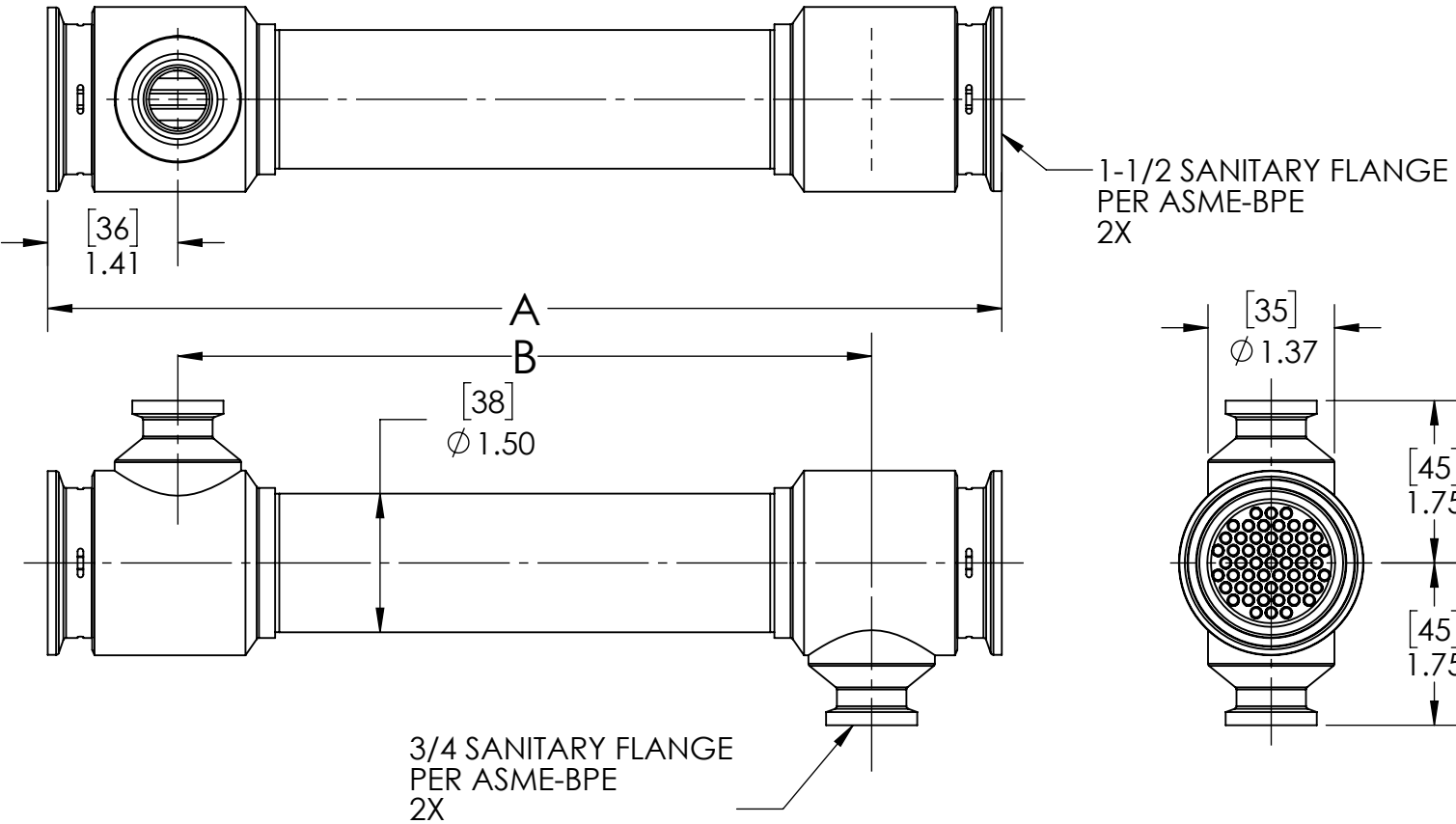

- #	TUBE COUNT	TUBE LENGTH		PRODUCT CONTACT SURFACE FINISH (NOTE 2)	CONFIG.	DIM A		DIM B		WEIGHT EMPTY		TRANSFER AREA	
		in	mm			in	mm	lb	kg	ft²	m²		
-25	55	10.00	254	SF4	W	10.30	262	7.50	191	3.19	1.4	1.33	0.12
-26		15.00	381			15.30	389	12.50	318	4.59	2.1	2.08	0.19
-27		20.00	508			20.30	516	17.50	445	5.54	2.5	2.83	0.26
-28		25.00	635			25.30	643	22.50	572	6.30	2.9	3.58	0.33
-29		30.00	762			30.30	770	27.50	699	7.09	3.2	4.33	0.40
-30		40.00	1016			40.30	1024	37.50	953	7.84	3.6	5.83	0.54
-31		10.00	254			10.30	262	7.50	191	3.19	1.4	1.33	0.12
-32		15.00	381			15.30	389	12.50	318	4.59	2.1	2.08	0.19
-33		20.00	508			20.30	516	17.50	445	5.54	2.5	2.83	0.26
-34		25.00	635			25.30	643	22.50	572	6.30	2.9	3.58	0.33
-35	30.00	762	30.30	770		27.50	699	7.09	3.2	4.33	0.40		
-36	40.00	1016	40.30	1024		37.50	953	7.84	3.6	5.83	0.54		
-37	91	10.00	254	SF4		10.30	262	7.50	191	3.19	1.4	1.66	0.15
-38		15.00	381			15.30	389	12.50	318	4.59	2.1	2.59	0.24
-39		20.00	508			20.30	516	17.50	445	5.54	2.5	3.53	0.33
-40		25.00	635			25.30	643	22.50	572	6.30	2.9	4.46	0.41
-41		30.00	762			30.30	770	27.50	699	7.09	3.2	5.39	0.50
-42		40.00	1016			40.30	1024	37.50	953	7.82	3.5	7.26	0.67
-43		10.00	254			10.30	262	7.50	191	3.19	1.4	1.66	0.15
-44		15.00	381			15.30	389	12.50	318	4.59	2.1	2.59	0.24
-45		20.00	508			20.30	516	17.50	445	5.54	2.5	3.53	0.33
-46		25.00	635			25.30	643	22.50	572	6.30	2.9	4.46	0.41
-47	30.00	762	30.30	770		27.50	699	7.09	3.2	5.39	0.50		
-48	40.00	1016	40.30	1024		37.50	953	7.82	3.5	7.26	0.67		

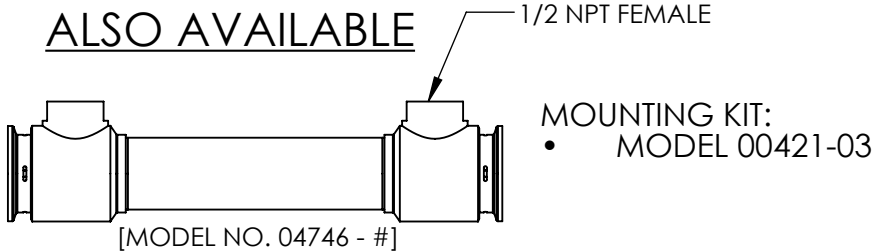

ALL DIMENSIONS ARE IN INCHES [mm]

**PROPRIETARY AND CONFIDENTIAL**

THE INFORMATION CONTAINED IN THIS DOCUMENT IS THE SOLE PROPERTY OF EXERGY, LLC. ANY REPRODUCTION, DISCLOSURE, OR USE, IN PART OR AS A WHOLE, WITHOUT THE WRITTEN PERMISSION OF EXERGY, LLC IS PROHIBITED.

PRODUCT SPECIFICATIONS SUBJECT TO CHANGE WITHOUT NOTICE. MANUFACTURER ASSUMES NO LIABILITY FOR MISUSE OR ABUSE OF PRODUCT. SPECIFIC WARRANTY INFORMATION IS AVAILABLE UPON REQUEST.

**THIRD ANGLE PROJECTION**

**ExERGY**  
HEAT TRANSFER SOLUTIONS

320 ENDO BLVD.  
GARDEN CITY, NY 11530  
USA (516)832-9300  
www.exergyllc.com

**SHELL & TUBE HEAT EXCHANGER  
35 SERIES SANITARY  
DTS, SANITARY ALL, RUGGED, HiP CLAMP**

MODEL NO. **04745- #**

DATE **4/6/2023** SCALE **1:2** SHEET **2 OF 4**

- NOTES:
- MATERIAL: 316L STAINLESS STEEL, NICKEL BRAZED.
  - PRODUCT CONTACT SURFACE FINISH CODE PER ASME-BPE:  
SF1: 20 µin. (.5 µm) Ra MAX  
SF4: 15 µin. (.4 µm) Ra MAX, ELECTROPOLISHED.
  - ALL EXTERNAL SURFACES SATIN FINISH.
  - MAXIMUM OPERATING CONDITIONS:
    - PRESSURE: TUBESIDE - 1200 psi (83 bar)  
SHELLSIDE - 800 psi (55 bar)  
(REFER TO SANITARY CLAMP MANUFACTURER FOR CLAMP PRESSURE RATING)
    - TEMPERATURE: 800°F (425°C)
    - PRESSURE FOR STEAM SERVICE: 125 psi (8.6 bar)
    - FLUID TEMPERATURE DIFFERENCE:  
 $(T_{HOT})_{AVE} - (T_{COLD})_{AVE} \leq 125^{\circ}F (70^{\circ}C)$
  - FULLY DRAINABLE ON TUBESIDE.
  - MATERIAL AND PROCESS CERTIFICATIONS PROVIDED.

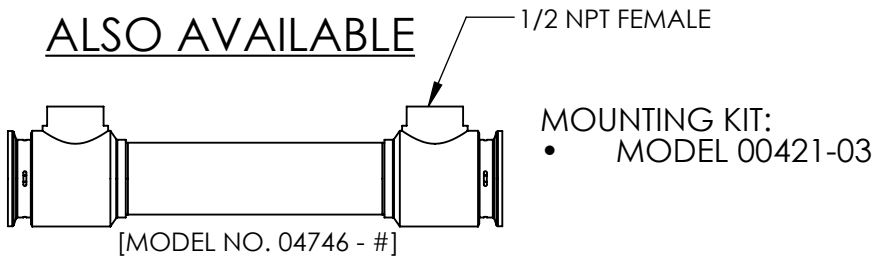
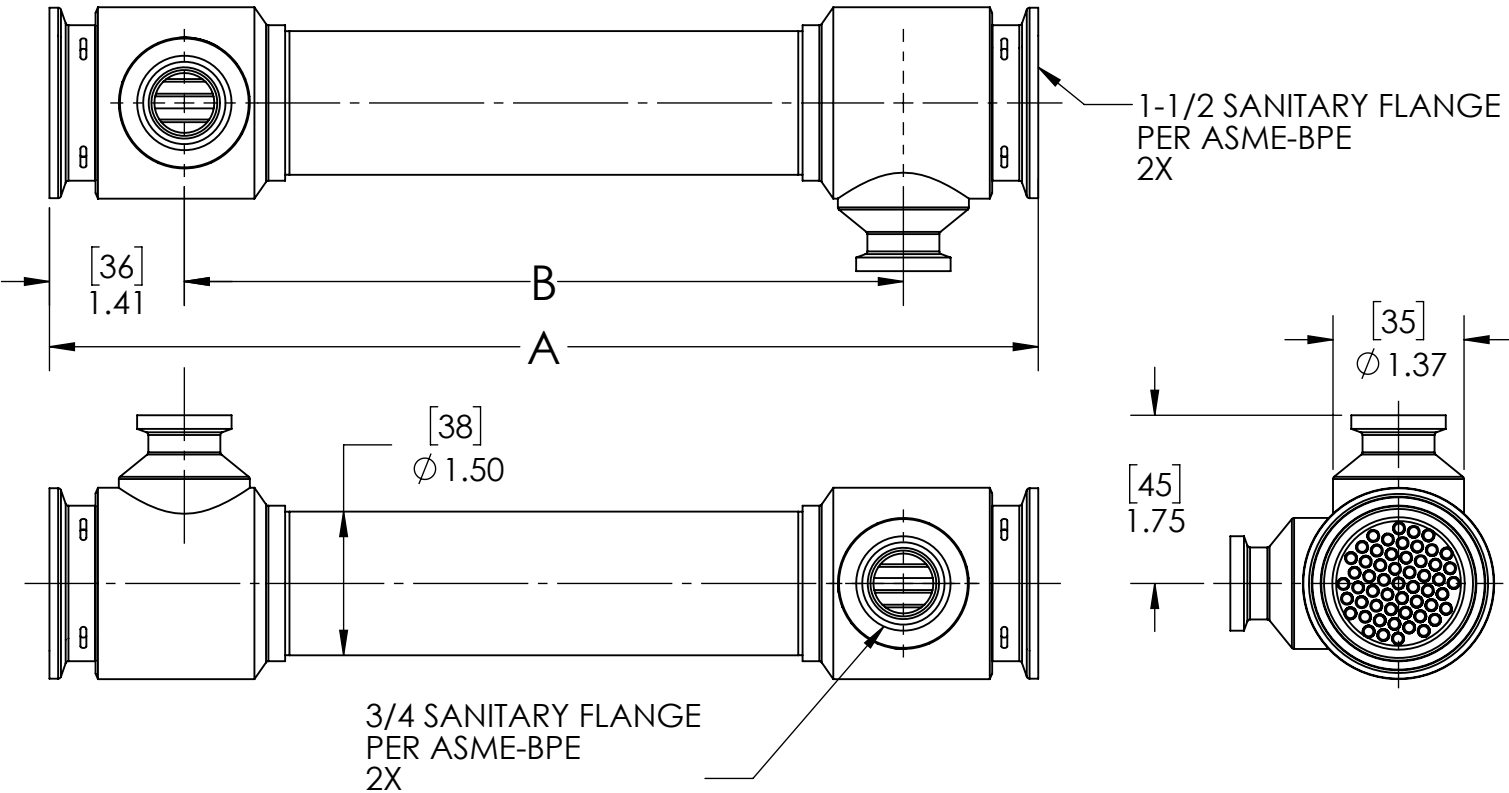

- #	TUBE COUNT	TUBE LENGTH		PRODUCT CONTACT SURFACE FINISH (NOTE 2)	CONFIG.	DIM A		DIM B		WEIGHT EMPTY		TRANSFER AREA	
		in	mm			in	mm	lb	kg	ft²	m²		
-49	55	10.00	254	SF4	X	10.30	262	7.50	191	3.19	1.4	1.33	0.12
-50		15.00	381			15.30	389	12.50	318	4.59	2.1	2.08	0.19
-51		20.00	508			20.30	516	17.50	445	5.54	2.5	2.83	0.26
-52		25.00	635			25.30	643	22.50	572	6.30	2.9	3.58	0.33
-53		30.00	762			30.30	770	27.50	699	7.09	3.2	4.33	0.40
-54		40.00	1016	40.30		1024	37.50	953	7.84	3.6	5.83	0.54	
-55		10.00	254	10.30		262	7.50	191	3.19	1.4	1.33	0.12	
-56		15.00	381	15.30		389	12.50	318	4.59	2.1	2.08	0.19	
-57		20.00	508	20.30		516	17.50	445	5.54	2.5	2.83	0.26	
-58		25.00	635	25.30		643	22.50	572	6.30	2.9	3.58	0.33	
-59	30.00	762	30.30	770		27.50	699	7.09	3.2	4.33	0.40		
-60	40.00	1016	40.30	1024		37.50	953	7.84	3.6	5.83	0.54		
-61	91	10.00	254	SF4		10.30	262	7.50	191	3.19	1.4	1.66	0.15
-62		15.00	381			15.30	389	12.50	318	4.59	2.1	2.59	0.24
-63		20.00	508			20.30	516	17.50	445	5.54	2.5	3.53	0.33
-64		25.00	635			25.30	643	22.50	572	6.30	2.9	4.46	0.41
-65		30.00	762			30.30	770	27.50	699	7.09	3.2	5.39	0.50
-66		40.00	1016	40.30		1024	37.50	953	7.82	3.5	7.26	0.67	
-67		10.00	254	10.30		262	7.50	191	3.19	1.4	1.66	0.15	
-68		15.00	381	15.30		389	12.50	318	4.59	2.1	2.59	0.24	
-69		20.00	508	20.30		516	17.50	445	5.54	2.5	3.53	0.33	
-70		25.00	635	25.30		643	22.50	572	6.30	2.9	4.46	0.41	
-71		30.00	762	30.30		770	27.50	699	7.09	3.2	5.39	0.50	
-72		40.00	1016	40.30		1024	37.50	953	7.82	3.5	7.26	0.67	

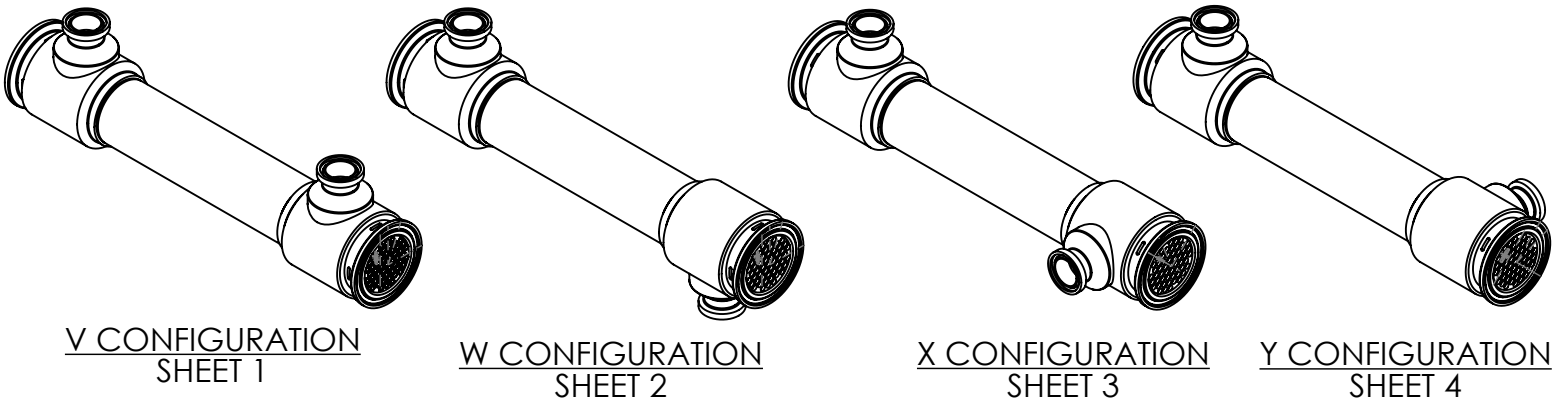

ALL DIMENSIONS ARE IN INCHES [mm]

**PROPRIETARY AND CONFIDENTIAL**

THE INFORMATION CONTAINED IN THIS DOCUMENT IS THE SOLE PROPERTY OF EXERGY, LLC. ANY REPRODUCTION, DISCLOSURE, OR USE, IN PART OR AS A WHOLE, WITHOUT THE WRITTEN PERMISSION OF EXERGY, LLC IS PROHIBITED.

PRODUCT SPECIFICATIONS SUBJECT TO CHANGE WITHOUT NOTICE. MANUFACTURER ASSUMES NO LIABILITY FOR MISUSE OR ABUSE OF PRODUCT. SPECIFIC WARRANTY INFORMATION IS AVAILABLE UPON REQUEST.

**THIRD ANGLE PROJECTION**

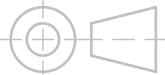

**ExERGY**  
HEAT TRANSFER SOLUTIONS

320 ENDO BLVD.  
GARDEN CITY, NY 11530  
USA (516)832-9300  
www.exergyllc.com

**SHELL & TUBE HEAT EXCHANGER  
35 SERIES SANITARY  
DTS, SANITARY ALL, RUGGED, HiP CLAMP**

MODEL NO. **04745- #**

DATE **4/6/2023** SCALE **1:2** SHEET **3 OF 4**

MODEL NO.  
**04745- #**



- NOTES:
- MATERIAL: 316L STAINLESS STEEL, NICKEL BRAZED.
  - PRODUCT CONTACT SURFACE FINISH CODE PER ASME-BPE:  
SF1: 20  $\mu$ in. (.5  $\mu$ m) Ra MAX  
SF4: 15  $\mu$ in. (.4  $\mu$ m) Ra MAX, ELECTROPOLISHED.
  - ALL EXTERNAL SURFACES SATIN FINISH.
  - MAXIMUM OPERATING CONDITIONS:
    - PRESSURE: TUBESIDE - 1200 psi (83 bar)  
SHELLSIDE - 800 psi (55 bar)  
(REFER TO SANITARY CLAMP MANUFACTURER FOR CLAMP PRESSURE RATING)
    - TEMPERATURE: 800°F (425°C)
    - PRESSURE FOR STEAM SERVICE: 125 psi (8.6 bar)
    - FLUID TEMPERATURE DIFFERENCE:  
 $(T_{HOT})_{AVE} - (T_{COLD})_{AVE} \leq 125^{\circ}F (70^{\circ}C)$
  - FULLY DRAINABLE ON TUBESIDE.
  - MATERIAL AND PROCESS CERTIFICATIONS PROVIDED.

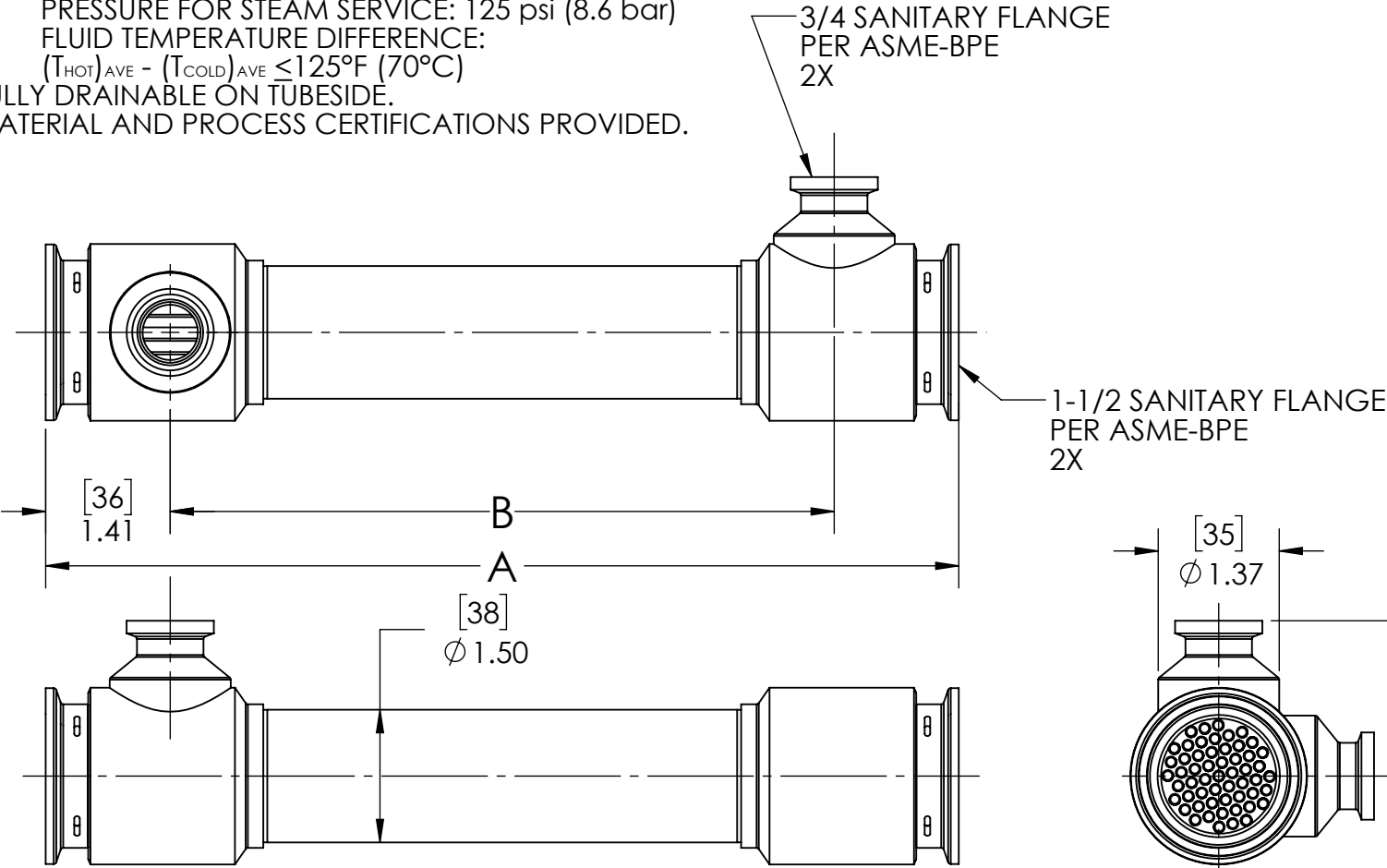

- #	TUBE COUNT	TUBE LENGTH		PRODUCT CONTACT SURFACE FINISH (NOTE 2)	CONFIG.	DIM A		DIM B		WEIGHT EMPTY		TRANSFER AREA	
		in	mm			in	mm	lb	kg	ft²	m²		
-73	55	10.00	254	SF4	Y	10.30	262	7.50	191	3.19	1.4	1.33	0.12
-74		15.00	381			15.30	389	12.50	318	4.59	2.1	2.08	0.19
-75		20.00	508			20.30	516	17.50	445	5.54	2.5	2.83	0.26
-76		25.00	635			25.30	643	22.50	572	6.30	2.9	3.58	0.33
-77		30.00	762			30.30	770	27.50	699	7.09	3.2	4.33	0.40
-78		40.00	1016			40.30	1024	37.50	953	7.84	3.6	5.83	0.54
-79		10.00	254			10.30	262	7.50	191	3.19	1.4	1.33	0.12
-80		15.00	381			15.30	389	12.50	318	4.59	2.1	2.08	0.19
-81		20.00	508			20.30	516	17.50	445	5.54	2.5	2.83	0.26
-82		25.00	635			25.30	643	22.50	572	6.30	2.9	3.58	0.33
-83	30.00	762	30.30	770		27.50	699	7.09	3.2	4.33	0.40		
-84	40.00	1016	40.30	1024		37.50	953	7.84	3.6	5.83	0.54		
-85	91	10.00	254	SF4		10.30	262	7.50	191	3.19	1.4	1.66	0.15
-86		15.00	381			15.30	389	12.50	318	4.59	2.1	2.59	0.24
-87		20.00	508			20.30	516	17.50	445	5.54	2.5	3.53	0.33
-88		25.00	635			25.30	643	22.50	572	6.30	2.9	4.46	0.41
-89		30.00	762			30.30	770	27.50	699	7.09	3.2	5.39	0.50
-90		40.00	1016			40.30	1024	37.50	953	7.82	3.5	7.26	0.67
-91		10.00	254			10.30	262	7.50	191	3.19	1.4	1.66	0.15
-92		15.00	381			15.30	389	12.50	318	4.59	2.1	2.59	0.24
-93		20.00	508			20.30	516	17.50	445	5.54	2.5	3.53	0.33
-94		25.00	635			25.30	643	22.50	572	6.30	2.9	4.46	0.41
-95	30.00	762	30.30	770		27.50	699	7.09	3.2	5.39	0.50		
-96	40.00	1016	40.30	1024		37.50	953	7.82	3.5	7.26	0.67		

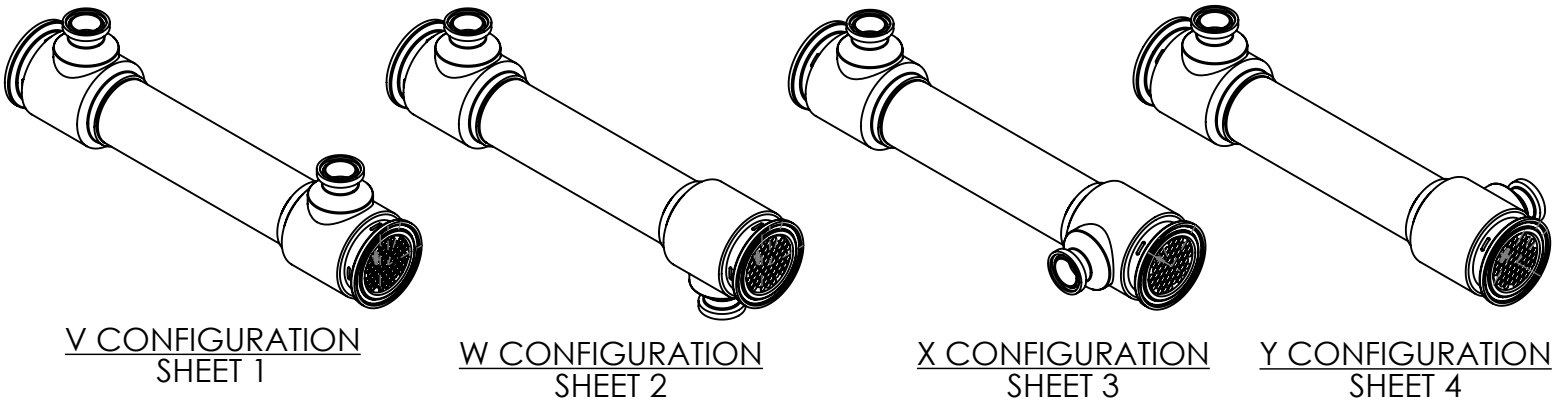
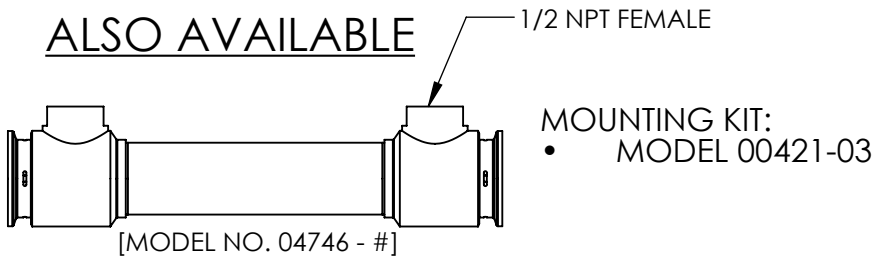

ALL DIMENSIONS ARE IN INCHES [mm]

**PROPRIETARY AND CONFIDENTIAL**  
THE INFORMATION CONTAINED IN THIS DOCUMENT IS THE SOLE PROPERTY OF EXERGY, LLC. ANY REPRODUCTION, DISCLOSURE, OR USE, IN PART OR AS A WHOLE, WITHOUT THE WRITTEN PERMISSION OF EXERGY, LLC IS PROHIBITED.

PRODUCT SPECIFICATIONS SUBJECT TO CHANGE WITHOUT NOTICE. MANUFACTURER ASSUMES NO LIABILITY FOR MISUSE OR ABUSE OF PRODUCT. SPECIFIC WARRANTY INFORMATION IS AVAILABLE UPON REQUEST.

**THIRD ANGLE PROJECTION**

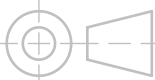

**EXERGY**  
HEAT TRANSFER SOLUTIONS

320 ENDO BLVD.  
GARDEN CITY, NY 11530  
USA (516)832-9300  
www.exergyllc.com

**SHELL & TUBE HEAT EXCHANGER**  
**35 SERIES SANITARY**  
**DTS, SANITARY ALL, RUGGED, HiP CLAMP**

MODEL NO. **04745- #**

DATE **4/6/2023** SCALE **1:2** SHEET **4 OF 4**